

Connecting footpaths defined, existing garden and wall adjusted to new shape

Five all new 4 x 4m picnic shelters, new furniture on 5 x 5m new concrete slabs

Retain public phone to improve access and surveillance

Overhead power lines and support poles transition park

Concrete pad for Christmas tree, an artwork option for rest of year

location of coffee van

Communication pits retained

Figs (2) removed

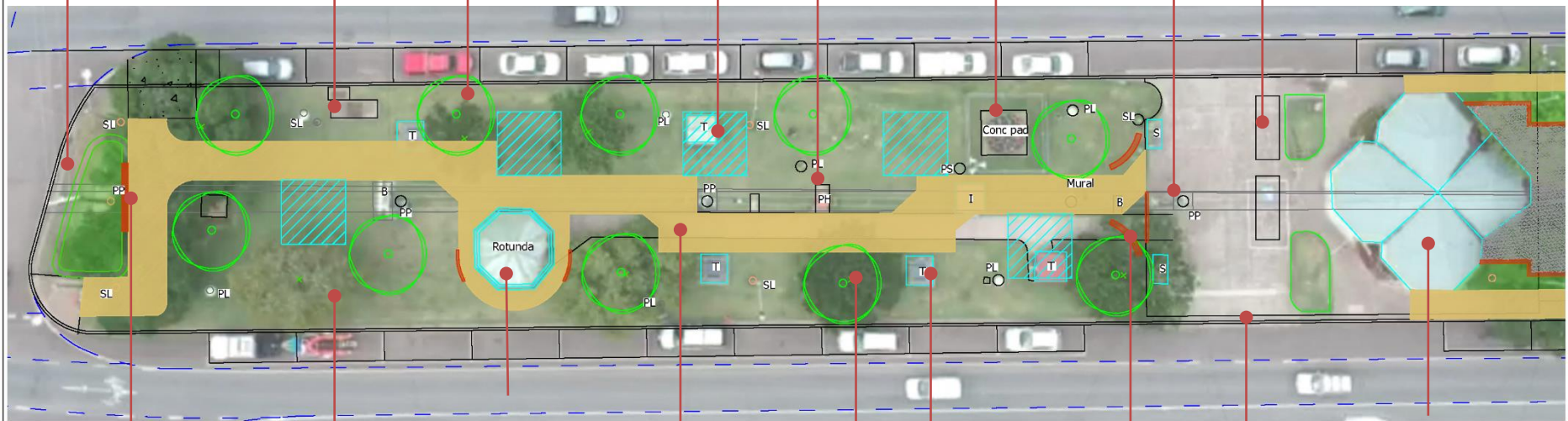

Long wall (600mm) with curved seat in central section. Plaques & info on outer sections of wall

Upgraded Park Rotunda, set within feature paved surrounds, low 'story' walls to side

Staged replacement of all trees with improved species

Curved walls (600mm) with curved seats on one side

Information centre option to improve connection with park and open space

Upgraded new lawns throughout space

Central main pedestrian promenade. Includes decorative inserts (lily theme), random seating, and lighting. (3m min width). Negotiates services and poles. Old concrete path sections removed

Former picnic table units and bases all removed

Install bike rack nearby

Repair cross over

North
NTS 

FOR REVIEW & COMMENT

MURGON Concept Plan Section East

JOINS .10

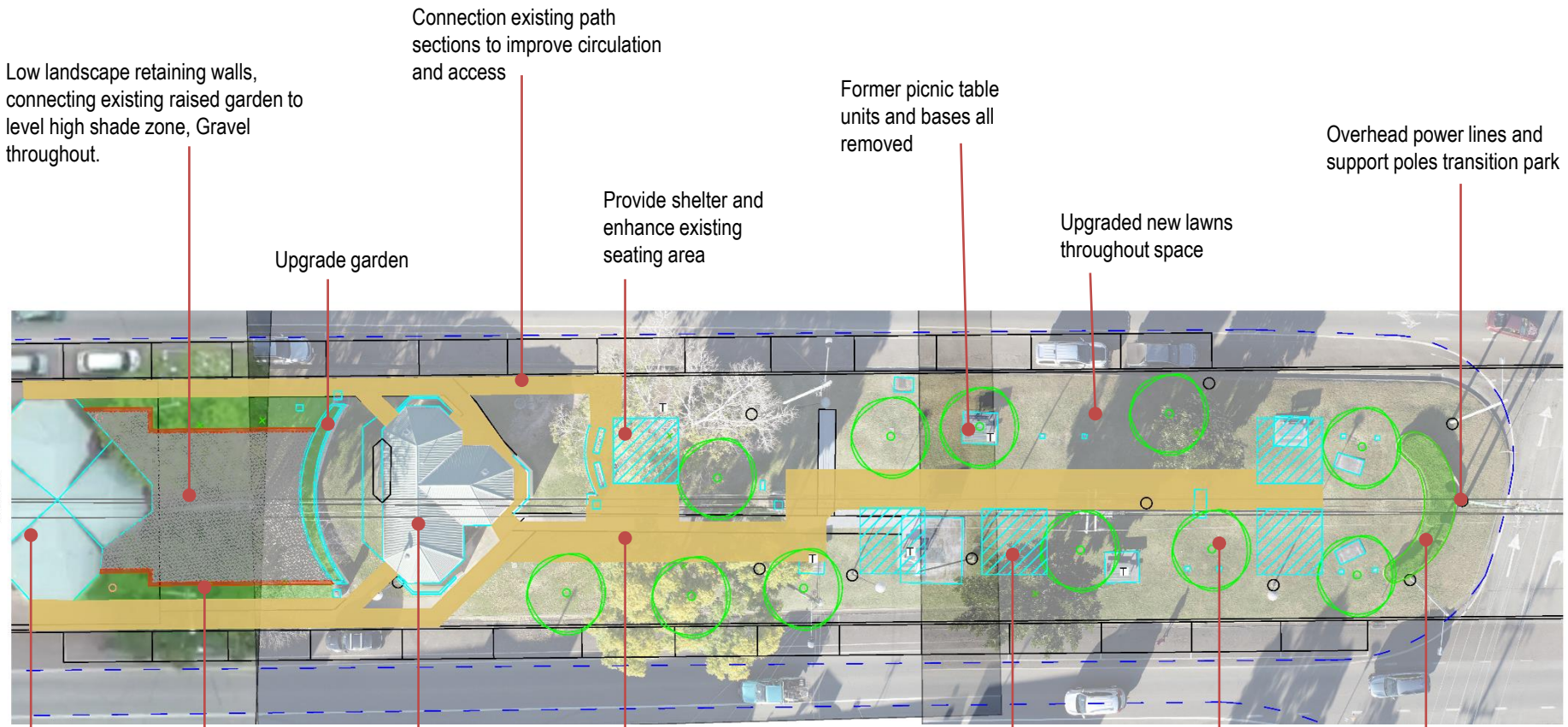

Low landscape retaining walls, connecting existing raised garden to level high shade zone, Gravel throughout.

Connection existing path sections to improve circulation and access

Former picnic table units and bases all removed

Overhead power lines and support poles transition park

Upgrade garden

Provide shelter and enhance existing seating area

Upgraded new lawns throughout space

Information centre

Toilet block retained, outer walls enhanced with contrasting colours

Five all new 4 x 4m picnic shelters, new furniture on 5 x 5m new concrete slabs

Staged replacement of all trees with improved species

Upgrade garden

New connecting retaining walls

Central main pedestrian promenade. Includes decorative inserts, random seating, and lighting. (3m min width). Negotiates services and poles. Old concrete path sections removed

North
NTS 

**FOR REVIEW &
COMMENT**

MURGON Concept Plan Section West